

**ALBERTA GOVERNMENT SERVICES
LAND TITLES OFFICE**

IMAGE OF DOCUMENT REGISTERED AS:

161287906

ORDER NUMBER: 31924006

ADVISORY

This electronic image is a reproduction of the original document registered at the Land Titles Office. Please compare the registration number on this coversheet with that on the attached document to ensure that you have received the correct document. Note that Land Titles Staff are not permitted to interpret the contents of this document.

Please contact the Land Titles Office at (780) 422-7874 if the image of the document is not legible.

CAVEAT

TO THE REGISTRAR OF THE ALBERTA LAND TITLES OFFICE

TAKE NOTICE that **S.R. HOMEOWNERS ASSOCIATION** (the "Caveator") of Edmonton, in the Province of Alberta, claims an interest under and by virtue of an Encumbrance Agreement in writing, dated October 24, 2016, and made between **SUNSET PROPERTIES INC.**, as registered owner, and the Caveator whereby the said registered owner and the Caveator agreed, all in accordance with the terms of the said Encumbrance Agreement, a true copy of which is attached to and forms part of this Caveat, in the lands described as follows:

See Schedule "A" attached hereto.

standing in the register in the name of **SUNSET PROPERTIES INC.**, and the Caveator forbids the registration of any person as transferee or owner of, or of any instrument affecting the said estate or interest, unless the instrument or Certificate of Title, as the case may be, is expressed to be subject to the Caveator's claim.

THE CAVEATOR DESIGNATES 900, 10310 Jasper Avenue, Edmonton, AB, T5J 1Y8, as the place at which notices and proceedings relating hereto may be served.

Dated this 24th day of October, 2016.

S.R. HOMEOWNERS ASSOCIATION

Corporate Seal

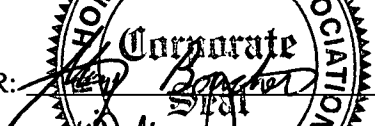
PER: 

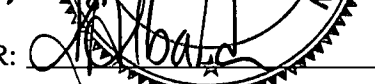
PER: 

AFFIDAVIT IN SUPPORT OF CAVEAT

I, KAREN ALBARDA, of the City of Edmonton, in the Province of Alberta, MAKE OATH AND SAY AS FOLLOWS:

1. That I am Agent for the Caveator.
2. I believe that the said Caveator has a good and valid claim upon the said land and I say that this Caveat is not being filed for the purpose of delaying or embarrassing any person interested in or proposing to deal therewith.

SWORN BEFORE ME Tanya Eklund
at the City of Edmonton, in the
Province of Alberta, this 24th
Day of October, A.D. 2016

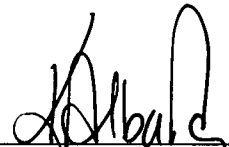

A COMMISSIONER FOR OATHS IN AND
FOR THE PROVINCE OF ALBERTA

) 

) _____

) KAREN ALBARDA

TANYA L. EKLUND
COMMISSION EXPIRES
MAY 24th, 2019

SCHEDULE "A"

PLAN 161 2165
BLOCK 28
LOTS 54 - 95 INCLUSIVE
EXCEPTING THEREOUT ALL MINES AND MINERALS

42

PLAN 161 2165
BLOCK 37
LOTS 9 - 15 INCLUSIVE
EXCEPTING THEREOUT ALL MINES AND MINERALS

7

ENCUMBRANCE AGREEMENT

MADE AS OF THIS 24th day of October, 2016.

BETWEEN:

SUNSET PROPERTIES INC.,
a body corporate incorporated under the laws of the Province of Alberta
(hereinafter called the "Developer")

OF THE FIRST PART

- and -

S. R. HOMEOWNERS ASSOCIATION,
a society incorporated under the *Societies Act* of Alberta
with registered office at 900, 10310 Jasper Avenue
in the City of Edmonton, in the Province of Alberta, T5J 1Y8
(hereinafter called the "Homeowners Association")

OF THE SECOND PART

WHEREAS:

- a. The Developer is registered as owner of lands in the Town of Cochrane, in the Province of Alberta described in Schedule "A" hereto (the "Current Lots");
- b. The Current Lots are part of a planned development in stages of lands that are herein described as the "Sunset Ridge Subdivision", being lands described in Schedule "B" hereto;
- c. The Developer owns lands within the Sunset Ridge Subdivision, as noted in Schedule "B" hereto;
- d. The Developer wishes to develop on the Sunset Ridge Subdivision a residential development for single-family homes and multi-family homes, special aspects of which are to be the sharing of maintenance of Subdivision Features by and through the Homeowners Association; and
- e. The Homeowners Association is (and may become) the holder of leases, easements and other rights in, to and over the Feature Lands, including:
 - i. easements and leases for Subdivision Features on Current Lots;
 - ii. easements or leases for the Subdivision Features from the municipality or other party; and

- iii. such other leases and easements as the Homeowners Association deems appropriate for the overall benefit of the Sunset Ridge Subdivision and its owners;
- f. The parties hereto intend to extend the operation of the arrangements provided for in this Agreement, made here applicable to the Current Lots, to subsequent subdivided portions of the Sunset Ridge Subdivision as and when created by subdivision plan; and
- g. The lands encompassed in the Homeowners Association's functions may in future be extended to the Added Lands (whether owned by the Developer or any other developer of lands).

NOW THEREFORE THE PARTIES HERETO AGREE AS FOLLOWS:

1. DEFINITIONS

IN THIS INSTRUMENT the following items have the following meanings:

- a. **"Added Lands"** means any and all lands adjacent to or near to the lands described in Schedule "B" hereto that fall within the Sunset Ridge Community Area Structure Plan on file with the Town of Cochrane and that may at any time or from time to time hereafter be included in the functions of the Homeowners Association and within the operation of this agreement.
- b. **"Current Lots"** means those lands described in Schedule "A" hereto;
- c. **"Feature Lands"** means the lands and areas of lands identified in Schedule "C" hereto and any other lands leased, licensed or owned by the Homeowner's Association or over which the Homeowner's Association assumes maintenance responsibilities from the municipality or otherwise.
- d. **"Homeowner's Association Costs"** shall have the meaning set out in paragraph 3c..
- e. **"Homeowners Association Land Interests"** means:
 - i. The leases and easements held by the Homeowners Association and the Developer on the Feature Lands;
 - ii. The leases, easements and other rights granted, or to be granted to the Homeowners Association by the Town of Cochrane for any other entrance gateways, fences, walkways, parks, signage and other features in the Sunset Ridge Subdivision; and
 - iii. Such other licenses, leases and easements within the Sunset Ridge Subdivision as the Homeowners Association hereafter acquires.

- f. **“Multi-Family Land”** means the parcel or parcels of land within the Sunset Ridge Subdivision that are now or may in future be developed as multi-family housing properties.
- g. **“Multi-Family Land Factor”** for a Multi-Family Land parcel is:
 - i. Fifteen (15) multiplied by the number of acres of land within the Multi-Family Land parcel if the Multi-Family Land is not subdivided or condominiumized further into Single-Family Building Lots, and
 - ii. The number of subdivided lots created within the Multi-Family Land if it is further subdivided or condominiumized into Single Family Building Lots.
- h. **“Ordinary Resolution”** means a resolution passed by a majority of eligible votes at a properly constituted meeting of the Homeowner’s Association, or a resolution in writing signed by eligible voters holding a majority of eligible votes.
- i. **“Owner”** means the registered owner in fee simple of a Current Lot.
- j. **“Rent Charge”** shall have the meaning set out in paragraph 3a.
- k. **“Rent Charge Proportion”** means:
 - i. As to all Single-Family Building Lots, a fraction equal to one (1) divided by the Rent Charge Total, and
 - ii. As to any Multi-Family Land parcel:
 - (1) If the Multi-Family Land remains unsubdivided or condominiumized into Single-Family Building Lots the fraction equal to the Multi-Family Land Factor divided by the Rent Charge Total, and
 - (2) If the Multi-Family Land is further subdivided or condominiumized into Single-Family Building Lots then for each lot or residential unit within such further subdivision the Rent Charge Proportion shall be equal to one divided by the Rent Charge Total.
- l. **“Rent Charge Total”** means the aggregate of the sum of:
 - i. 1 times the number of Single-Family Building Lots, plus
 - ii. The aggregate Multi-Family Land Factors for all Multi-Family Land parcels that have not been subdivided or condominiumized into Single-Family Building Lots,

situate from time to time within the Sunset Ridge Subdivision and Added Lands (if any), as determined by the Homeowners Association from time to time.

- m. **"Single-Family Building Lot"** means:
 - i. A detached single-family residential lot,
 - ii. A semi-detached (duplex) residential lot, or
 - iii. A fee simple townhouse lot or a bare-land condominium unit suitable for a single-detached, semi-detached or townhouse residence.
- n. **"Subdivision Features"** includes patterned sidewalks, lighted stone structures, stone walls, fencing, decorative street lamps, landscaped cul-de-sac islands, walkways, electrical power and lighting, medians and boulevards, public utility lots, flower beds, parks and landscaping and other facilities now or hereafter constructed in the Sunset Ridge Subdivision the care or maintenance of which may be undertaken from time to time by the Homeowners Association.
- o. **"Sunset Ridge Subdivision"** means lands described in Schedule "B" hereto and includes the Current Lots, and such other subdivided lots as may hereafter become parts of the subdivision known as Sunset Ridge, and includes Added Lands, if any (the extent and boundaries of which shall be determined by the Homeowners Association).
- p. **"Term"** means the period commencing on January 1, 2012, and expiring on December 31, 2111.

2. THE HOMEOWNERS ASSOCIATION

- a. Rights and Obligations of the Homeowners Association
 - i. Notwithstanding the foregoing, the Owner acknowledges that the Homeowners Association or the Town of Cochrane and their respective successors and assigns may replace Subdivision Features, as required from time to time due to maintenance or otherwise, with materials of a different nature, character, quality or appearance as those Subdivision Features being replaced. Without limiting the generality of the foregoing, the Owner acknowledges that portions of exposed aggregate sidewalks may be replaced with another material or with exposed aggregate of a different colour.
 - ii. Responsibilities. The Homeowners Association, shall be responsible for the management and control of all Subdivision Features, and shall keep the same in good, clean and proper condition, order and repair.
 - iii. Manager. The Homeowners Association may obtain, employ and pay for the services of any entity or person (hereinafter called the "Manager") to assist in managing its affairs and carrying out its rights and obligations hereunder to the extent it deems advisable, as well as such other personnel as the Homeowners Association shall determine to be necessary or desirable, whether such personnel are furnished or employed directly by the Homeowners Association or by the Manager. Without limitation, the Homeowners Association may contract with or employ the Developer or

an associated company to perform and exercise (and in the Homeowners Association so contracting the Developer and the representatives it elects shall be free to exercise the Developer's voting right in the Homeowners Association) its rights and obligations or to act as Manager for any period. Any management agreement must be terminable for cause upon thirty (30) days notice, be for a term not to exceed three years, and be renewable only upon mutual consent of the parties.

- iv. Implied Rights. The Homeowners Association may exercise other rights or privileges given to it expressly by this Agreement, its Articles or Bylaws, or by law, and every other right or privilege reasonably necessary to effectuate the exercise of any right or privileges granted herein or therein.

3. COVENANT FOR MAINTENANCE ASSESSMENTS

- a. There shall be payable to the Homeowners Association from time to time, as assessed and levied by the Homeowners Association from time to time, by the registered owner in fee simple of each Current Lot including each parcel of Multi-Family Land, a sum equal to such Single Family Building Lot's or Multi-Family Land's (as the case may be) Rent Charge Proportion of the Homeowners Association's Costs, as and by way of a rent charge (the "Rent Charge"). If a Multi-Family Land parcel is hereafter subdivided or condominiumized into Single-Family Building Lots from and after the registration of the plan for such subdivision or condominium, the Rent Charge Proportion applicable to such Multi-Family Land parcel shall become equal to the number of Single-Family Building Lots created by such plan, and the Rent Charge Proportion applicable to such Multi-Family Land parcel will thereafter be the same for each Single-Family Building Lot so created as it is for any other Single-Family Building Lot.
- b. The Developer hereby, as registered owner in fee simple of each of the Current Lots subject to such liens, encumbrances and interests as are endorsed hereon, grants to the Homeowners Association a Rent Charge as against and in respect of each such Current Lot, equal as to each such Current Lot, to the lesser of:
 - i. In each case an amount equal to:
 - (1) \$600.00 for each Single-Family Building Lot per annum during the Term or such other amount as is determined by Ordinary Resolution pursuant to paragraph 3(c); and
 - (2) \$9,000.00 per acre for Multi-Family Lands (that have not been subdivided or condominiumized into a Single-Family Building Lot) per annum during the Term or such other amount as is determined by Ordinary Resolution pursuant to paragraph 3(c);
 - ii. the Rent Charge Proportion of the Homeowners Association's Costs applicable to such Current Lot, from time to time during the Term hereof determined as herein provided for;

and encumbers mortgages and charges each such Current Lot as security for payment of the Rent Charge applicable to each such Current Lot (respectively).

- c. "Homeowners Association's Costs" for any period shall mean any and all costs incurred or to be incurred in such period (including without limitation reasonable reserves for future maintenance, repair and replacement costs) by the Homeowners Association in and in respect of carrying out and exercising its rights, duties and obligations hereunder, as determined by the Board of Directors of the Homeowners Association from time to time. Notwithstanding the foregoing, and notwithstanding Paragraph 3(b) hereof, the Homeowners Association's costs for any Current Lot except the Multi-Family Land (unless the latter is subdivided or condominiumized into a Single-Family Building Lot) shall not exceed the amount per annum applicable for such Lot under section 3(b)(i)(1) hereof (and as to the Multi-Family Land as long as it remains unsubdivided or condominiumized as aforesaid shall not exceed the amount per annum applicable for such Lot under 3(b)(i)(2)) unless authorized by Ordinary Resolution of the members of the Homeowners Association.
- d. The Owner from time to time of each Current Lot shall pay the Rent Charge applicable to his Current Lot as and whenever required by the Homeowners Association. The Board of Directors of the Homeowners Association shall from time to time estimate the Homeowners Association's Costs (including without limitation reserves for maintenance, repair and replacement costs) for such period as it deems convenient to its administration and shall notify each Owner of the amount of such estimate and the Owner's share thereof (that is, his Rent Charge) by notice in writing given in accordance with paragraph 5 hereof. Each such estimate shall state the amount of the Rent Charge payable for the period. The Rent Charge for each Current Lot shall be the sum so notified by the Homeowners Association as applicable to the Current Lot and such Rent Charge for such period shall be due and payable on or before the 30th day following notice of the Rent Charge. If a Multi-Family Land Parcel is condominiumized by a condominium plan that does not create Single-Family Building Lots then the Rent Charge applicable to the Multi-Family Land Parcel shall be notified to the condominium corporation created on such plan registration and such Rent Charge notification shall be binding upon all owners of units in such condominium as if each owner had been separately and specifically notified as of the date of notification to the condominium corporation. Further, the Rent Charge applicable to such Multi-Family Land Parcel shall be and remain a charge and encumbrance on all units and common property within the said parcel.
- e. The Rent Charge shall be and is hereby made an encumbrance upon each respective Current Lot and the Homeowners Association shall have and be entitled to enforce such Rent Charge against each such (respective) lot in the same manner as provided for an "encumbrance" under the *Land Titles Act* of Alberta.
- f. The said Rent Charge shall run with and bind the title to each such respective Current Lot and to each condominium unit and related common property interest.
- g. Notwithstanding anything herein contained no Rent Charge shall be levied, assessed or payable for any period prior to the date on which the Developer has

transferred lots in the Sunset Ridge Subdivision to Owners which lots in the aggregate contain at least 200 residential units ready for occupancy on which there are at least 200 residential units being occupied and the Developer gives notice to the Homeowner's Association in writing (which notice shall be in the discretion of the Developer) that it shall turn over the management functions for the Sunset Ridge Subdivision to the Homeowner's Association (the "Turnover Date"); and the Developer shall provide all duties and functions of the Homeowners Association at the Developer's sole cost and expense prior to such Turnover Date. The Developer shall, as shall all Owners, be subject to all Rent Charges levied on lots in the Sunset Ridge Subdivision owned by them (respectively) from and after the Turnover Date. Upon each Owner acquiring a lot from the Developer, the Developer shall set aside and hold in trust for the Homeowners Association and accounted for by the Developer in its management function as above provided, a sum not less than \$100.00 for each Single Family Building Lot acquired, and \$1,500.00 per acre for each acre in a Multi-Family Land parcel acquired. No Rent Charges shall be payable in respect of unsubdivided remainder parcels owned by the Developer or against any commercial (non-residential) lands or lots.

- h. The Board of Directors of the Homeowners Association shall (subject to the limitation stated in paragraph 3(c) hereof) be the sole determiner of the Homeowners Association's Costs, the Rent Charge Proportion, the amount of the Rent Charges from time to time and the dates on which they are payable; and a certificate stating the same and signed by two or more Directors of the Homeowners Association, or signed by an officer of the Developer if the Developer is then a member of the Homeowners Association, shall be conclusive and binding on all Owners within the Sunset Ridge Subdivision (including without limitation the Owners of the Current Lots). The Board of Directors of the Homeowners Association shall, for and on behalf of the Homeowners Association, determine the lots including Multi-Family Lands in addition to the Current Lots that fall within the Sunset Ridge Subdivision from time to time; and the foregoing certificate provisions shall apply as such determination.
- i. Without limiting the foregoing, the Homeowners Association hereby confirms that the Rent Charge for each Current Lot for the initial one year period commencing on the Turnover Date, has been set at the sum of:

- (a) \$100.00 per annum for each Single-Family Building Lot, and

- (b) \$1,500.00 per annum per acre for each parcel of Multi-Family Lands,

and such Rent Charge shall be payable on or before the 30th day following the Turnover Date. If the Homeowners Association or its Board of Directors fails or omits to determine or notify Owners of the Rent Charge for any portion of the Term hereof after the Turnover Date, or if the Rent Charge for any portion of the Term shall otherwise not be ascertained or ascertainable then the Rent Charge for such portion of the Term shall be and be deemed to be the sum per annum set out in subsections 3(i)(a) and 3(i)(b) (respectively) payable in one instalment for each Current Lot.

- j. Any Rent Charge not paid when due shall bear interest (and the Owner of the Current Lot in default shall pay interest on the Rent Charge in default) at the rate of SIXTEEN (16%) per cent per annum calculated monthly, not in advance, from the date due until paid; and such interest shall be and is hereby made a charge upon the said lot.
- k. The Homeowners Association shall be at liberty, in its sole discretion, to postpone the Rent Charge and Encumbrance herein provided for, in respect of any Current Lot, to a registered first mortgage of such lot, on such terms and conditions as the Homeowners Association may require, which may include (without limitation) a requirement for payment of a fee for and expenses incurred (including solicitor-and-his-own-client fees and disbursements) in connection with same.

4. **TERM**

This Agreement and the rights, licences, interests, privileges and charges hereby granted shall be for a term of one hundred (100) years commencing on January 1, 2012, and expiring December 31, 2111.

5. **NOTICE**

Notices hereunder may be given to an Owner of a Current Lot by delivery to, or by prepaid ordinary mail addressed to, such Owner's Current Lot, or by publication in a local newspaper circulating in Cochrane, Alberta. Notices to the Homeowners Association may be given by personal delivery to the registered office of the Homeowners Association or by personal service on a member of the Board of Directors of the Homeowners Association. Notices to Current Lot Owners may be addressed to "Members" or "Occupants" or "Owners" or "Residents" or any similar designation, and do not need to state the Members' names. If a parcel is part of a condominium property, notices to all owners of units in such condominium will be deemed to be given on delivery or posting by ordinary mail to the registered address of the condominium corporation, or on newspaper publication as aforesaid.

6. **MISCELLANEOUS**

- a. This Agreement shall enure to the benefit of and be binding upon the parties hereto and their respective successors and assigns.
- b. If any part of this Agreement shall be void, unlawful or unenforceable for any reason whatsoever, such part shall be severable from this agreement without affecting or derogating from the validity and enforceability of the remainder hereof.

IN WITNESS WHEREOF the parties have each hereunto affixed its respective seal as witnessed by the hands of its proper officers duly authorized in that behalf as of the day and year first above written.

SUNSET PROPERTIES INC.
Per: [Signature]
Per: [Signature]

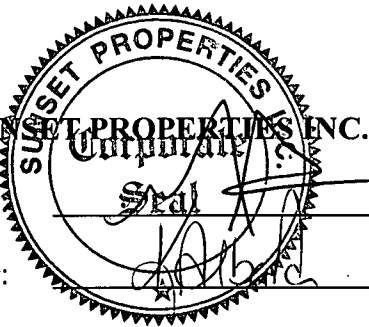
A circular seal for Sunset Properties Inc. with a serrated outer edge. The text "SUNSET PROPERTIES INC." is written around the top inner edge. The seal is stamped over two lines of text, each starting with "Per:". The first line has a handwritten signature, and the second line has another handwritten signature.

S. R. HOMEOWNERS ASSOCIATION
Per: [Signature]
Per: [Signature]

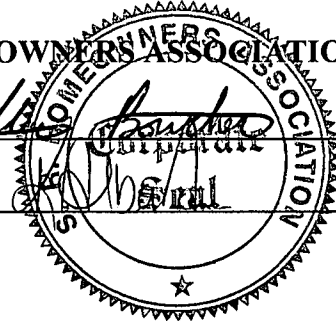
A circular seal for S. R. Homeowners Association with a serrated outer edge. The text "S. R. HOMEOWNERS ASSOCIATION" is written around the top inner edge. A small star is located at the bottom center of the seal. The seal is stamped over two lines of text, each starting with "Per:". The first line has a handwritten signature, and the second line has another handwritten signature.

SCHEDULE "A"

TO ENCUMBRANCE AGREEMENT

The Current Lots are legally described as follows, all being lots shown on the subdivision plan registered as Plan No. 161 2165, namely:

Block 28, Lots 54 to 95 inclusive

Block 37, Lots 9 to 15 inclusive

SCHEDULE "B"

TO ENCUMBRANCE AGREEMENT

The Sunset Ridge Subdivision is located within the lands legally described (prior to the subdivision referred to in Schedule "A" hereto) as follows and as outlined in bold in the attached Schedule B-1:

PLAN 0610825

AREA C

CONTAINING 1.658 HECTARES (4.10 ACRES) MORE OR LESS

EXCEPTING THEREOUT:

PLAN	NUMBER	HECTARES	ACRES	MORE OR LESS
SUBDIVISION	0710615	0.002	0.005	
SUBDIVISION	0812355	0.122	0.30	
SUBDIVISION	0911115	0.542	1.34	
SUBDIVISION	1213594	0.543	1.34	
SUBDIVISION	1411831	0.447	1.105	

EXCEPTING THEREOUT ALL MINES AND MINERALS

MERIDIAN 5 RANGE 4 TOWNSHIP 26

SECTION 11

THAT PORTION OF THE NORTH WEST QUARTER

WHICH LIES NORTH OF THE ROADWAY AS SHOWN ON PLAN 646BM

CONTAINING 59.181 HECTARES (146.2 ACRES) MORE OR LESS

EXCEPTING THEREOUT:

PLAN	NUMBER	HECTARES	ACRES	MORE OR LESS
SUBDIVISION	0712595	1.938	4.79	
SUBDIVISION	0810726	5.787	14.30	
SUBDIVISION	0812355	2.213	5.47	
SUBDIVISION	0813662	7.019	17.34	
SUBDIVISION	1313277	2.753	6.80	

EXCEPTING THEREOUT ALL MINES AND MINERALS

DESCRIPTIVE PLAN 0511019

BLOCK 1

LOT 1

EXCEPTING THEREOUT:

PLAN	NUMBER	HECTARES	ACRES	MORE OR LESS
SUBDIVISION	0614690	2.537	6.27	
SUBDIVISION	0710615	5.735	14.17	
SUBDIVISION	0710898	2.471	6.11	
PUBLIC WORKS PLAN (ROAD)	0715041	3.365	8.32	
SUBDIVISION	0812355	0.031	0.08	
SUBDIVISION	0911115	1.431	3.54	
SUBDIVISION	1213594	2.943	7.27	
SUBDIVISION	1411831	0.568	1.404	

EXCEPTING THEREOUT ALL MINES AND MINERALS

THE ORIGINAL ROAD ALLOWANCE ADJOINING THE SOUTH BOUNDARY
OF THE SOUTH WEST QUARTER OF SECTION 14

IN TOWNSHIP 26

RANGE 4

WEST OF THE FIFTH MERIDIAN

CONTAINING 1.62 HECTARES (4 ACRES) MORE OR LESS

EXCEPTING THEREOUT:

PLAN	NUMBER	HECTARES	ACRES	MORE OR LESS
SUBDIVISION	0812355	0.222	0.55	
SUBDIVISION	0813662	0.392	0.97	
SUBDIVISION	1313277	1.006	2.48	

EXCEPTING THEREOUT ALL MINES AND MINERALS

MERIDIAN 5 RANGE 4 TOWNSHIP 26

SECTION 14

QUARTER NORTH WEST

CONTAINING 64.7 HECTARES (160 ACRES) MORE OR LESS

EXCEPTING THE SUBDIVISION ON PLAN 1364LK CONTAINING

17.54 HECTARES (43.36 ACRES) MORE OR LESS

EXCEPTING THEREOUT:

PLAN	NUMBER	HECTARES	ACRES	MORE OR LESS
SUBDIVISION	1411831	1.367	3.38	

EXCEPTING THEREOUT ALL MINES AND MINERALS

PLAN 0610825

AREA D

CONTAINING 1.615 HECTARES (3.99 ACRES) MORE OR LESS

EXCEPTING THEREOUT:

PLAN	NUMBER	HECTARES	ACRES	MORE OR LESS
SUBDIVISION	1411831	0.50	1.24	

EXCEPTING THEREOUT ALL MINES AND MINERALS

MERIDIAN 5 RANGE 4 TOWNSHIP 26

SECTION 14

QUARTER SOUTH WEST

CONTAINING 64.7 HECTARES (160 ACRES) MORE OR LESS

EXCEPTING THEREOUT:

PLAN	NUMBER	HECTARES	(ACRES)	MORE OR LESS
ROAD	1774BM	1.61	3.99	
SUBDIVISION	0812355	0.392	0.97	
SUBDIVISION	0813662	0.780	1.93	
SUBDIVISION	0911115	4.908	12.13	
SUBDIVISION	1112901	3.743	9.25	
SUBDIVISION	1213594	3.556	8.79	
SUBDIVISION	1313277	10.874	26.87	
SUBDIVISION	1411831	5.704	14.09	
SUBDIVISION	1412251	5.597	5.68	
SUBDIVISION	1512560	3.145	7.77	
SUBDIVISION	1512587	3.234	7.99	

EXCEPTING THEREOUT ALL MINES AND MINERALS



Sunset Ridge Stage 2 Neighbourhood Plan

Legal Descriptions:
Portions of NW & SW 14-26-4-W5, NW 11 26-4-W5,
Plan 0511019 BIK 1 Lot 1, Plans: 0610825 Blocks C & D
& Other Title 26-4-W5M

Prepared for:
SUNSET PROPERTIES INC.

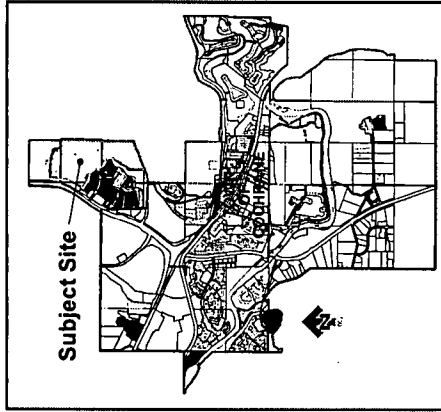

Location map

- Single Detached Dwelling
 - Single and Two Dwelling District
 - Multi-unit Dwelling District
 - High Density Multi-dwelling District
 - Municipal Reserve
 - Environmental Reserve
 - Stormwater Management Facility
-
- Cochrane City Limits
 - Neighbourhood Plan Boundary
 - Contour Interval 5m
 - Monolithic Sidewalk
 - Separate Sidewalk
 - Regional Pathway 3.0m
 - Local Asphalt Pathway 3.0m
 - Local Granular Pathway 1.5-2.0m
 - Regional Pathway by Others 3.0m
 - Bus Stop Location
 - Enhanced Pedestrian Crossing



Notes:

All roads are residential standard (9m/15m) unless otherwise noted. All lanes are 6.0m wide

SUNSET RIDGE NEIGHBOURHOOD PLAN STATISTICS

Category	Area (m ²)	Area (acres)	Percentage of Total Area	Number of Units	% of GDA
Total Land Area	10,114	25.14	100%		
Stormwater Management Facility	1,111	2.74	11.0%		
Environmental Reserve	1,111	2.74	11.0%		
Municipal Reserve	1,111	2.74	11.0%		
High Density Multi-dwelling District	1,111	2.74	11.0%	306	8.5%
Single and Two Dwelling District	1,111	2.74	11.0%	306	8.5%
Single Detached Dwelling	1,111	2.74	11.0%	306	8.5%
Multi-unit Dwelling District	1,111	2.74	11.0%	306	8.5%
Other	1,111	2.74	11.0%	306	8.5%
Total	10,114	25.14	100%	3,618	100%

* See Municipal Reserve breakdown in the Appendix

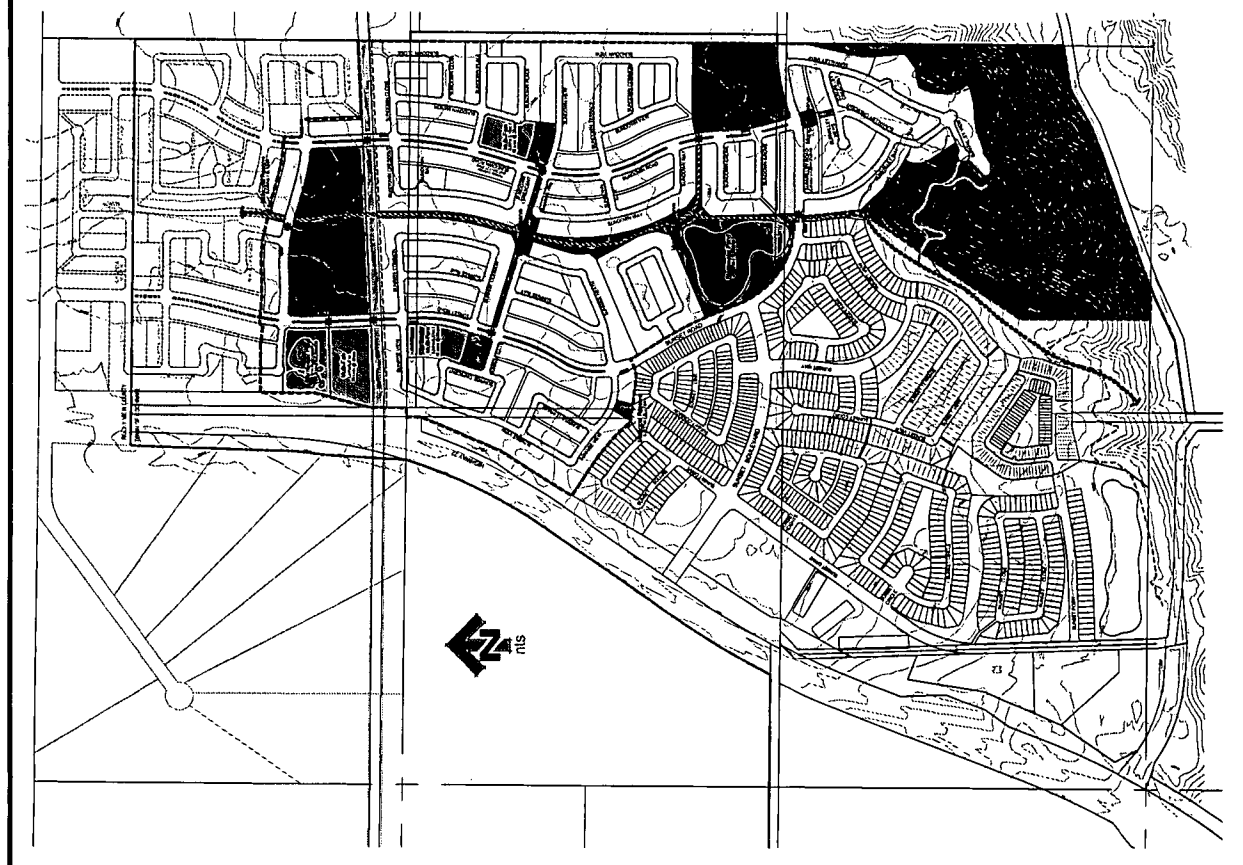

SCHEDULE "C"

TO ENCUMBRANCE AGREEMENT

Feature Land Areas comprise of those easement areas outlined in the attached as Schedule "C-1"

SCHEDULE "C-1" EASEMENT, LEASE AGREEMENT AND RESTRICTIVE COVENANT

AFFECTING
LOT 53 TO 63 INCLUSIVE BLOCK 28 PLAN 161 2165
WITHIN THE
SW 1/4 SEC 14 TWP 26 RGE 4 W5M



LEGEND

1.2m Wrought Iron fence within a one (1) metre right of way shown thus:
 © Copyright Global Raymac Surveys Inc. 2016.

Date: 19th October 2016
 Job No. 14CX0048
 File No. 14CX0048-RC2

GLOBAL RAYMAC SURVEYS INC.
 Suite 312, 4000 - 4th ST SE Calgary, Alberta T2G 2W3
 Ph: 403.283.5455 www.globalraymac.ca



161287906

161287906 REGISTERED 2016 12 01
CAVE - CAVEAT
DOC 1 OF 3 DRR#: D0F1E0A ADR/CALKAKOS
LINC/S: 0037317005 +